



Nature & Home

Construction method

NATURE & HOME

Tél: 01 89 70 16 12 | Email: contact@natureandhome.fr 142

bis Avenue Thibaud de Champagne, 77144 Montévrain Site:

www.natureandhome.fr | SIRET: 943 864 827 00010

Wooden frame

Our expertise is based on a sustainable construction method using high-quality, environmentally friendly materials.



Exterior wall sections

Our walls are designed with a high-quality timber frame, guaranteeing both strength and optimal thermal insulation for your garden house.

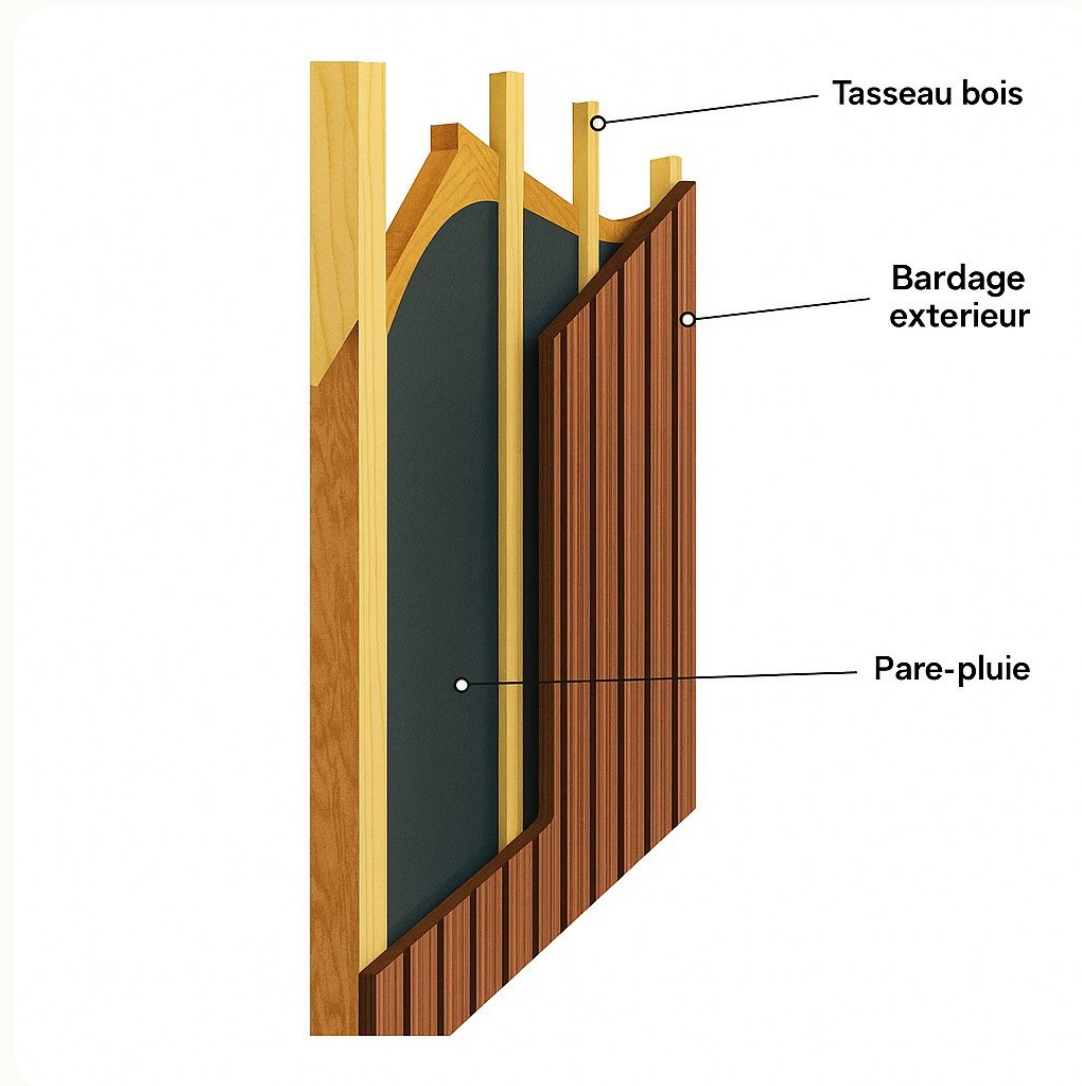

Our construction technique guarantees perfectly straight and stable walls, offering excellent value for money while meeting the strictest construction standards.

Composite cladding or wood or steel cladding

Our houses feature cladding that offers exceptional durability and aesthetics for your garden house.

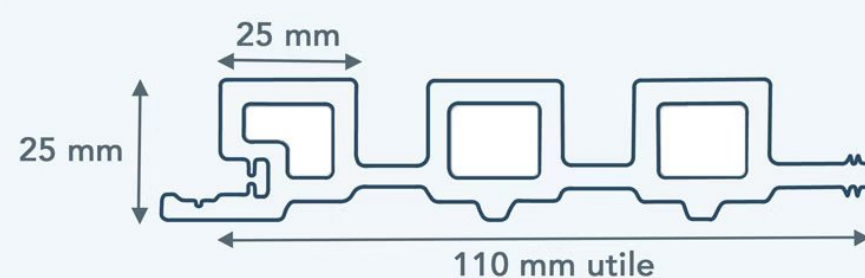

PROFIL XS EN CARRÉ
ULTRAPROTECT



Choose from our range of elegant colours to perfectly personalise the exterior of your garden house.

Section of interior walls

Our walls are carefully designed to offer you optimal thermal and acoustic comfort in your garden house.

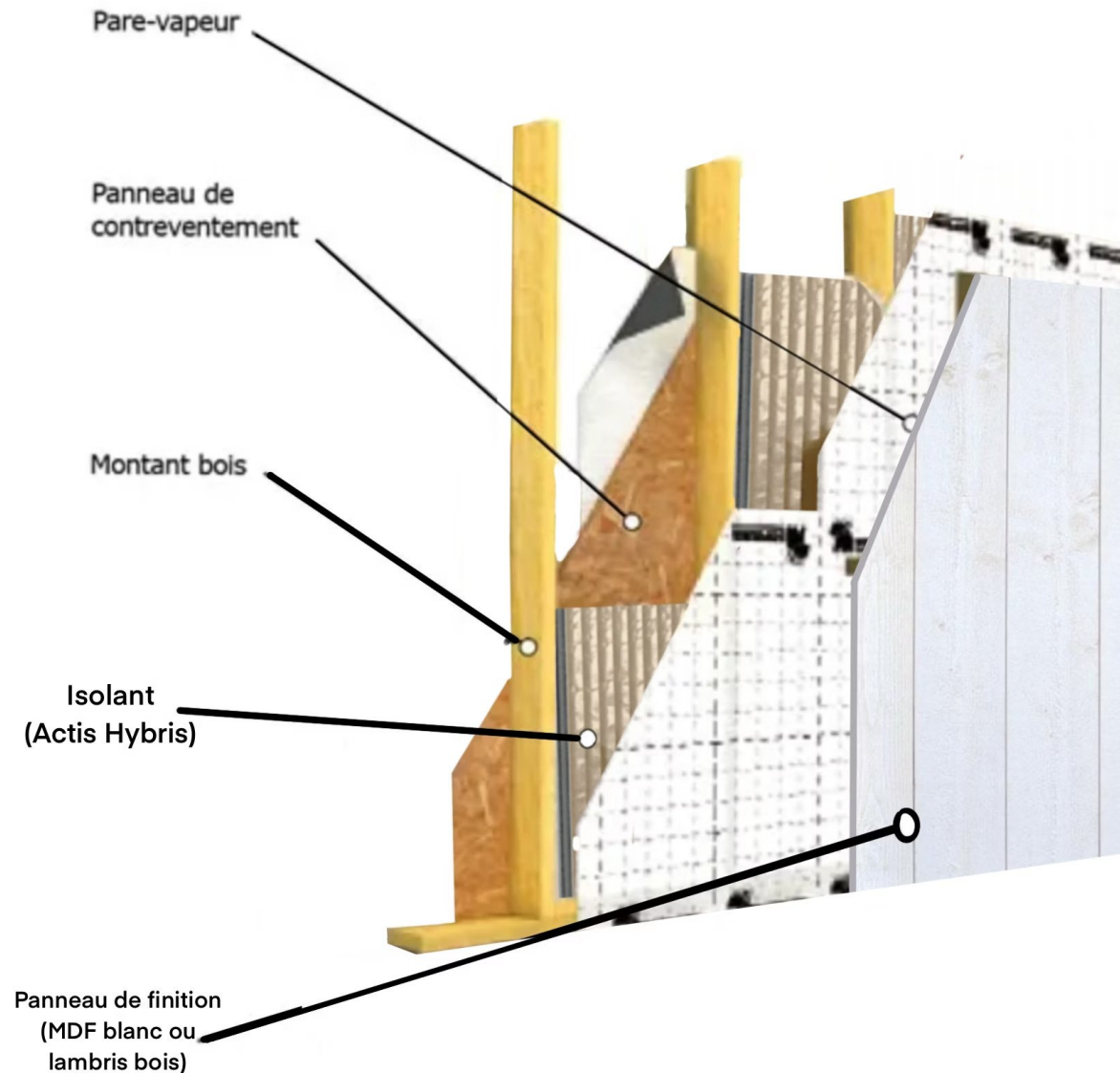

Our high-performance insulation and quality finishes create a pleasant and energy-efficient living space, whatever the season.

Roof waterproofing

Our garden houses benefit from a high-performance sealing system, guaranteeing optimal protection against weather and humidity.

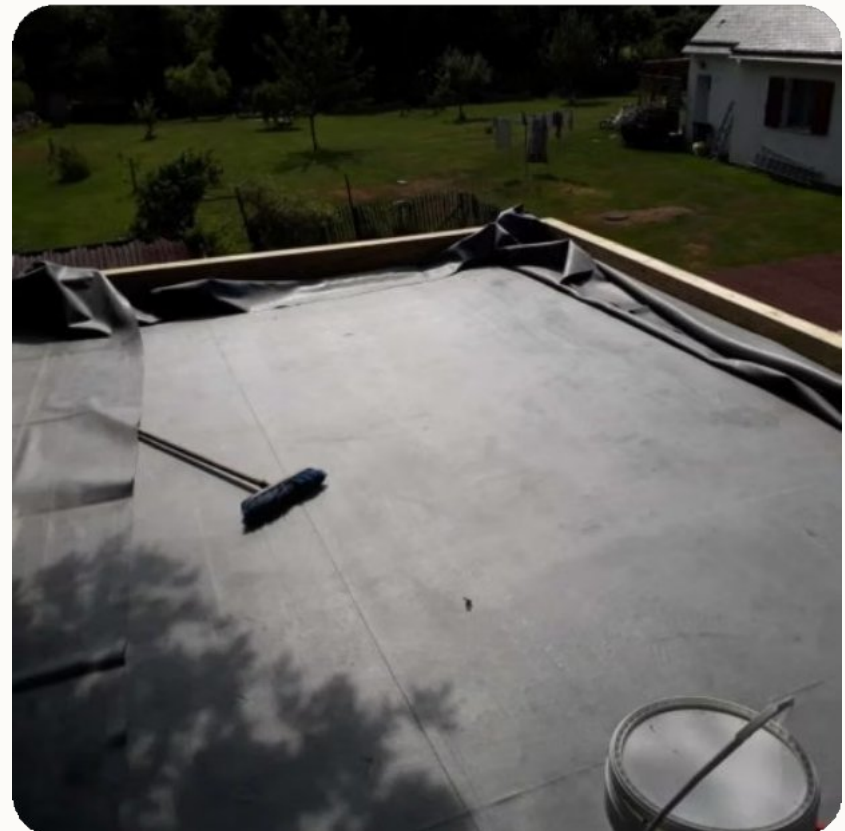
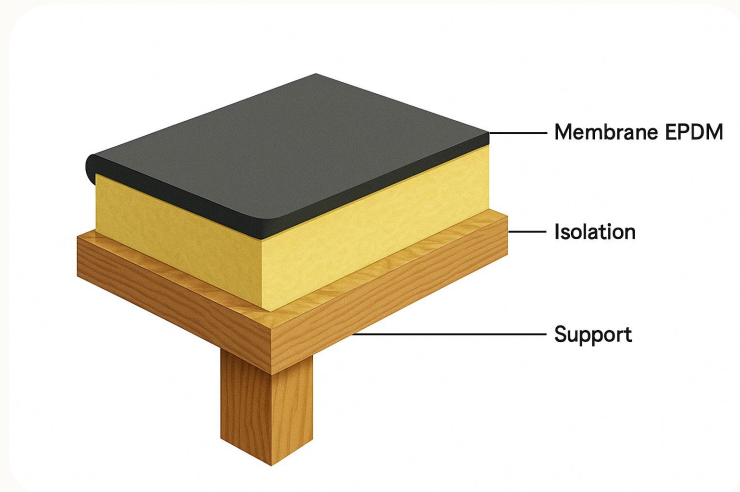

We use top-quality waterproof materials to ensure the longevity of your construction and preserve the integrity of your outdoor living space.

Each joint is carefully treated to prevent any water infiltration, thus offering you a perfectly dry and comfortable garden house in all seasons.

Carpentry

Joinery is an essential element of our garden houses. It contributes not only to the aesthetics of the structure, but also to its insulation and durability. Our teams of expert joiners use high-quality materials to design windows, doors, and other joinery elements that integrate perfectly with the overall structure.

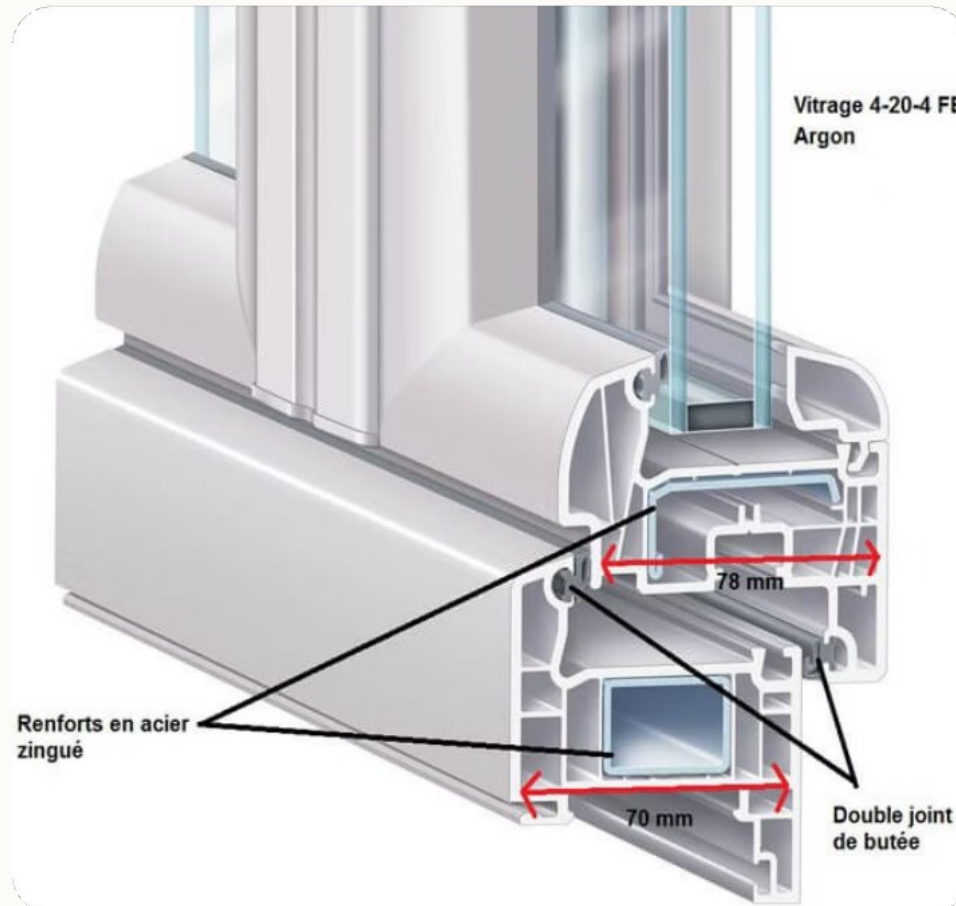

PVC cut



ALU cup

Whether you choose wood, composite, or steel cladding, our carpenters know how to showcase these materials to create an elegant and harmonious appearance. They pay particular attention to details, such as the cuts of exterior and interior walls, to guarantee a neat and professional finish.

Floor Structure

The floor structure of our garden sheds is designed to offer stability, durability, and optimal insulation. We use high-quality treated wood beams that ensure excellent resistance to loads and climatic variations.

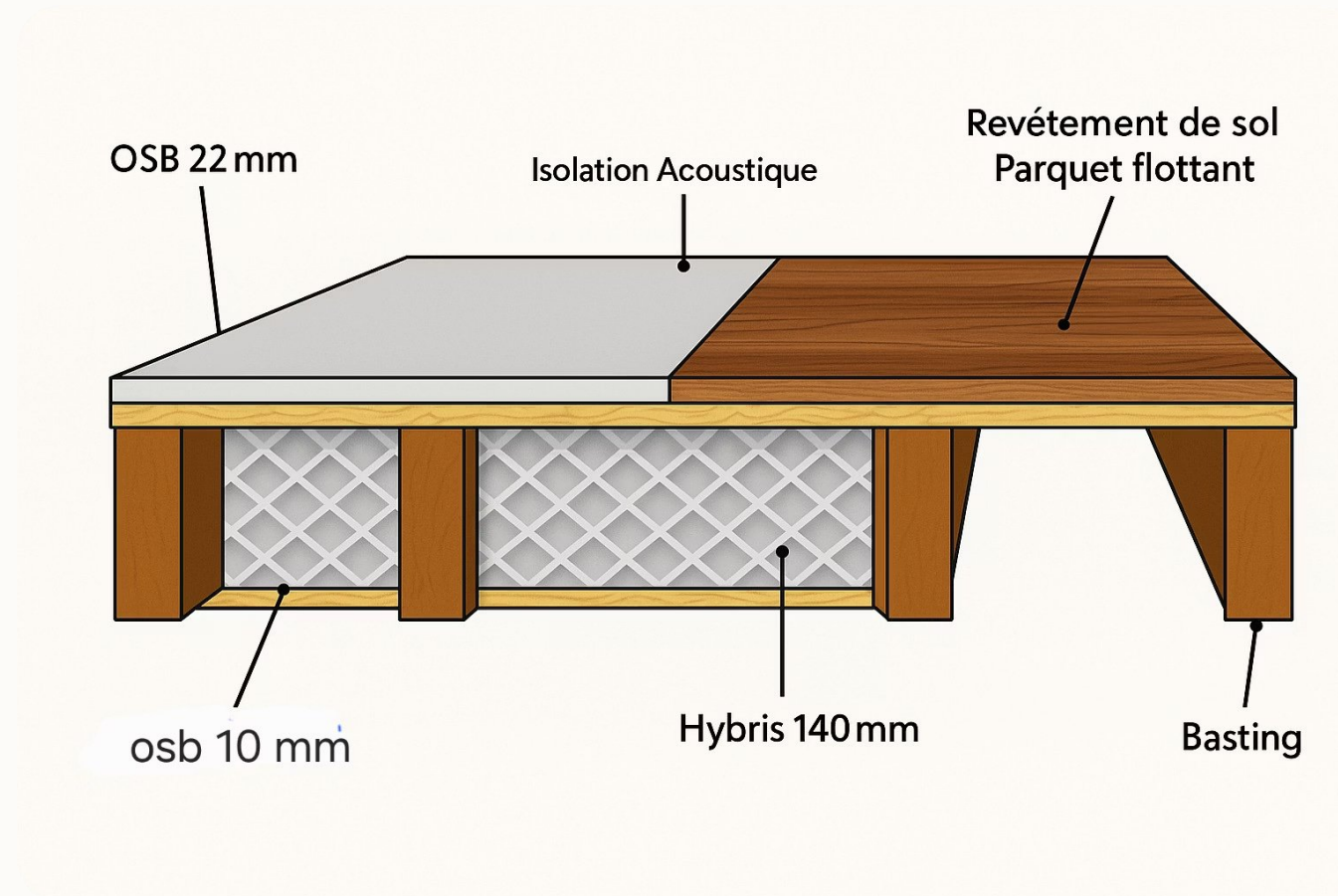

Each floor is composed of several technical layers: a load-bearing structure of joists, a high-performance thermal insulation layer, a vapor barrier to prevent rising damp, and a robust finishing coating suitable for everyday use.

This multi-layered design not only guarantees perfect insulation against cold and damp ground, but also ensures exceptional longevity for your entire garden house. Our floors are also treated against insects and fungi for complete protection of your investment.

Roof Structure

The roof structure of our garden houses is designed to provide optimal protection against the elements while offering excellent thermal insulation. We use high-quality solid wood beams, strategically positioned to guarantee exceptional resistance to snow loads and strong winds.



Cold System



Hot System

Each roof is composed of several technical layers: a solid treated wood frame, a high-performance waterproofing membrane, a layer of reinforced thermal insulation, and a durable exterior cladding adapted to varying climatic conditions. This multi-layered design provides complete protection against water infiltration and contributes to the energy efficiency of your space.

Our roofs are also designed to blend seamlessly with the overall aesthetic of our garden houses, featuring meticulous finishes and clean lines. Whether it's a modern flat roof or a more traditional pitched roof, each structure is crafted with precision by our experienced carpenters to ensure the durability and beauty of your investment for many years to come.

Foundations

The foundations of our garden houses are designed to offer optimal stability and exceptional durability. We use high-quality materials to ensure your structure rests on a solid, weather-resistant base.



Foundation screws



Each project begins with a soil composition analysis, if necessary, to determine the most suitable foundation type for your site. Whether it's concrete pad foundations, strip footings, or reinforced concrete slabs, we guarantee professional installation that complies with all building standards..

Our foundations are also designed to minimize environmental impact while maximizing the longevity of your garden house, creating a harmonious structure that blends seamlessly into your outdoor space.

HYBRIS Insulation

31's HYBRIS insulation is a high-performance, multi-layer reflective insulation solution. Combining reflective films and insulating foams, it offers excellent thermal resistance while remaining thin and lightweight.

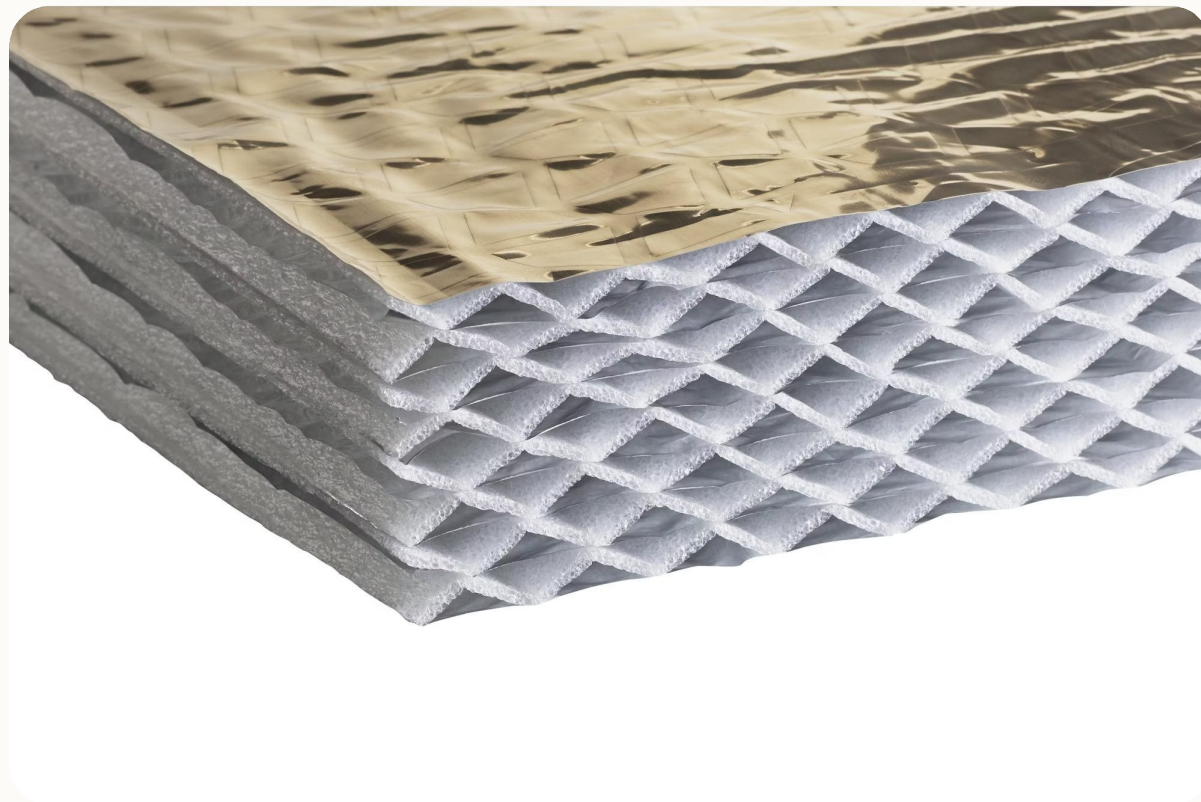

Particularly well-suited for our timber-frame constructions, HYBRIS provides effective insulation against the cold in winter and the heat in summer. Its honeycomb structure and metallized films create successive barriers that limit heat transfer by radiation, convection, and conduction.

This modern insulation is also appreciated for its ease of installation, resistance to moisture and durability, guaranteeing the thermal comfort of your garden house for many years.

Interior wall coverings

Discover our interior coating solutions combining aesthetics, durability and comfort for your outdoor living space.



White Melamine



Wood paneling

All our coatings are selected for their compatibility with our HYBRIS insulation systems, thus guaranteeing optimal thermal performance and year-round living comfort.

Floor coverings

Our garden houses are equipped with high-quality floor coverings, combining aesthetics, durability and ease of maintenance for optimal comfort.

We offer various options to suit your needs and style: laminate flooring or PVC vinyl, also known as engineered wood flooring. All our floor coverings are selected for their resistance to temperature variations.



Floating parquet flooring



Synthetic parquet flooring

Each solution offers a neat finish that blends perfectly with interior wall coverings, creating a warm and inviting space for your Nature & Home garden house..